



ISABELLA COURT, HARROW ROAD
WARLINGHAM, SURREY, CR6 9EY

FLAT 3 ISABELLA COURT, HARROW ROAD WARLINGHAM, SURREY, CR6 9EY

Rayners are delighted to present to the market this two bedroom, first floor apartment. In our opinion, the property is beautifully presented throughout with modern and well appointed kitchen open plan to the living area, modern bathroom and fresh decor throughout. Situated in a block of only four flats and located within a popular, residential road close to open countryside as well as amenities at Warlingham Village. Benefitting from private parking. Viewing is highly recommended.

Tenure: Leasehold

Lease Length: Approx 112 years remaining.

Local Authority: Tandridge District Council

Tax Band: C

Maintenance Fee: Approx £1200

Ground Rent: £250 per year

EPC Rating: D

3 Isabella Court

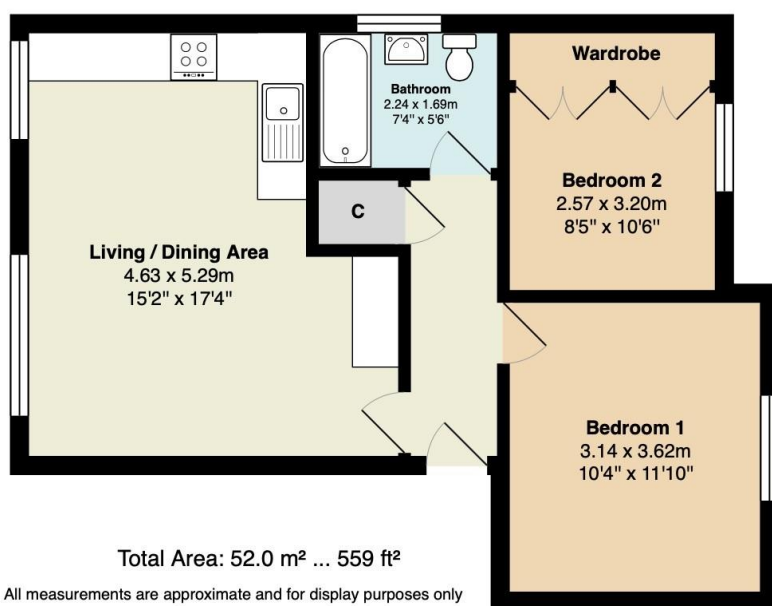

2 GLEBE ROAD, WARLINGHAM, SURREY, CR6 9NJ
01883 622 258
warlingham@raynersproperties.com
www.raynersproperties.com

RAYNERS
TOWN & COUNTRY

IMPORTANT: we would like to inform prospective purchasers that these sales particulars have been prepared as a general guide only. A detailed survey has not been carried out, nor the services, appliances and fittings tested. Room sizes should not be relied upon for furnishing purposes and are approximate. If floor plans are included, they are for guidance only and illustration purposes only and may not be to scale. If there are any important matters likely to affect your decision to buy, please contact us before viewing the property. R772